

CAPE SEAL

PROJECT LOCATION MAP

NOT TO SCALE

SITE "A"

DESIGNED:	DATE: 6/6/16
S. ZAHORI	
DELINEATED:	DATE: 6/6/16
K. NOZUKA	
CHECKED:	DATE:
J. MANZI	
SCALE:	NOT TO SCALE

CITY OF REDWOOD CITY
 COMMUNITY DEVELOPMENT DEPARTMENT
 ENGINEERING AND TRANSPORTATION
 CALIFORNIA

2015 - 2016 ASPHALT RUBBER CAPE SEAL AND SPOT REPAIR PROJECT

SHT 1 OF 4

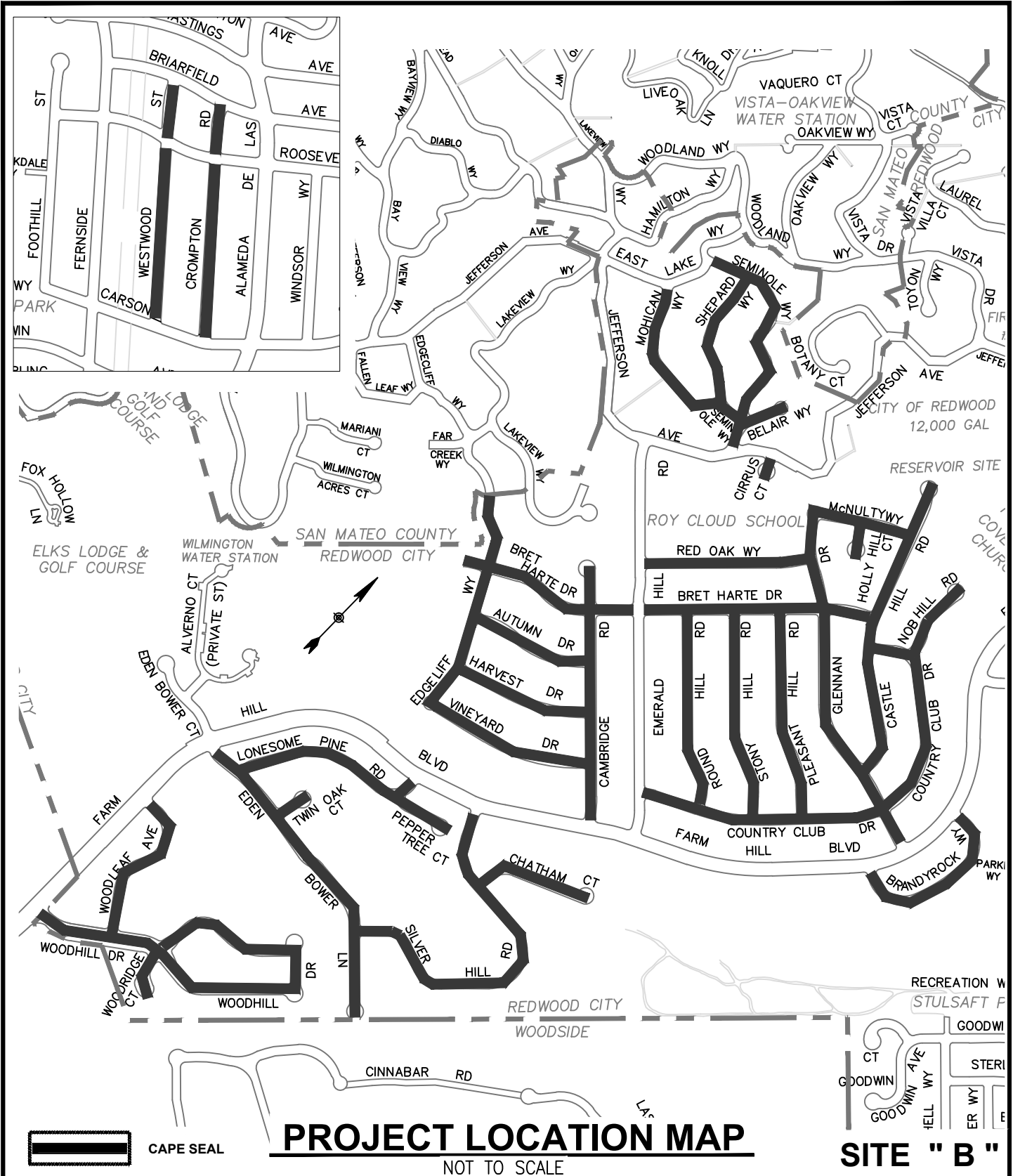

PROJECT LOCATION MAP
NOT TO SCALE

SITE " B "



DESIGNED:	DATE: 6/6/16
S. ZAHORI	
DELINEATED:	DATE: 6/6/16
K. NOZUKA	
CHECKED:	DATE:
J. MANZI	
SCALE:	NOT TO SCALE

CITY OF REDWOOD CITY
 COMMUNITY DEVELOPMENT DEPARTMENT
 ENGINEERING AND TRANSPORTATION
 CALIFORNIA

2015 - 2016 ASPHALT RUBBER CAPE SEAL AND SPOT REPAIR PROJECT

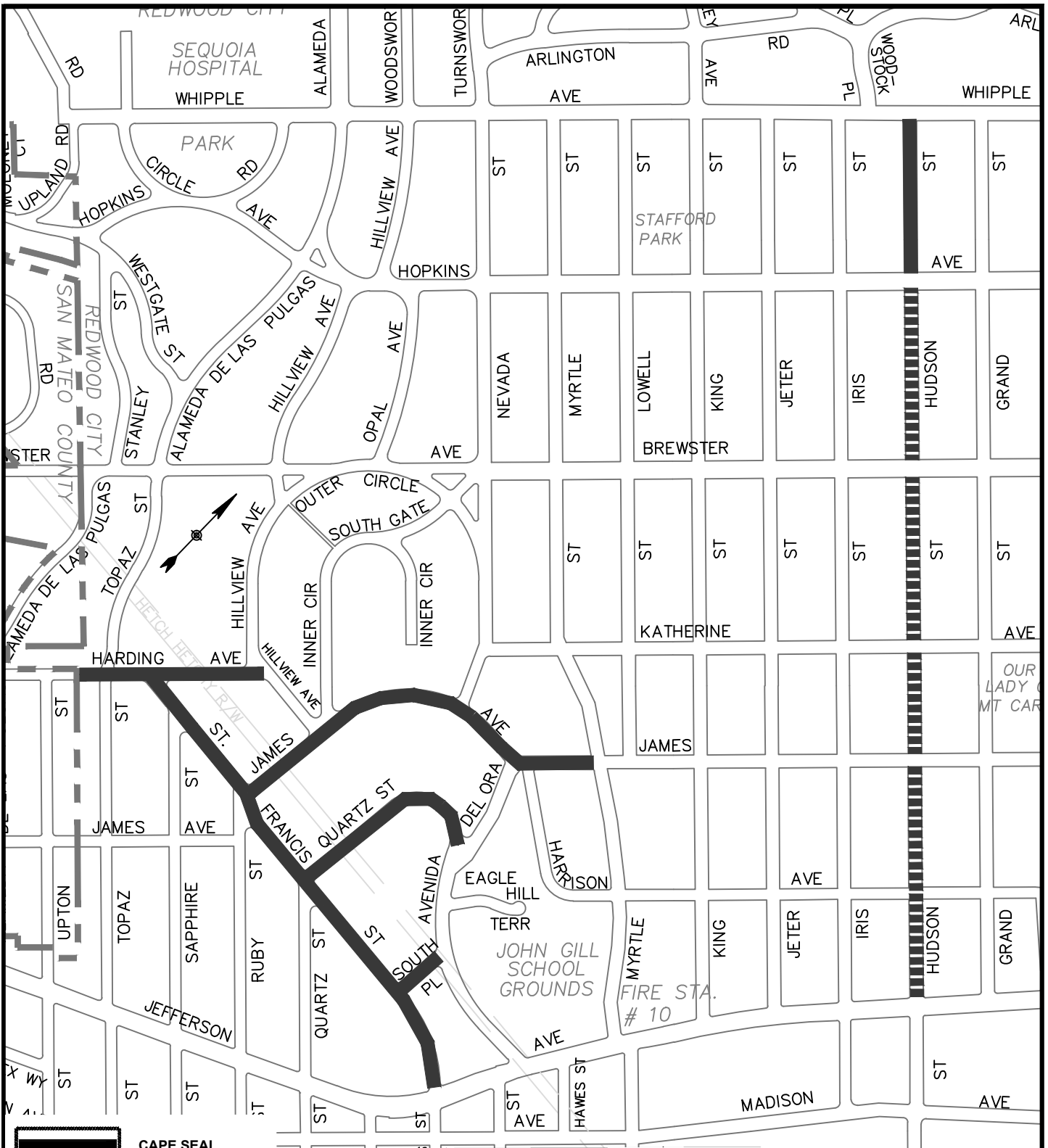
SHT 2 OF 4



-  CAPE SEAL
-  MICRO SURFACING

PROJECT LOCATION MAP

NOT TO SCALE

SITE " C "

DESIGNED:	DATE: 6/6/16
S. ZAHORI	
DELINEATED:	DATE: 6/6/16
K. NOZUKA	
CHECKED:	DATE:
J. MANZI	
SCALE:	NOT TO SCALE

CITY OF REDWOOD CITY
 COMMUNITY DEVELOPMENT DEPARTMENT
 ENGINEERING AND TRANSPORTATION
 CALIFORNIA

2015 - 2016 ASPHALT RUBBER CAPE SEAL AND SPOT REPAIR PROJECT

SHT 3 OF 4

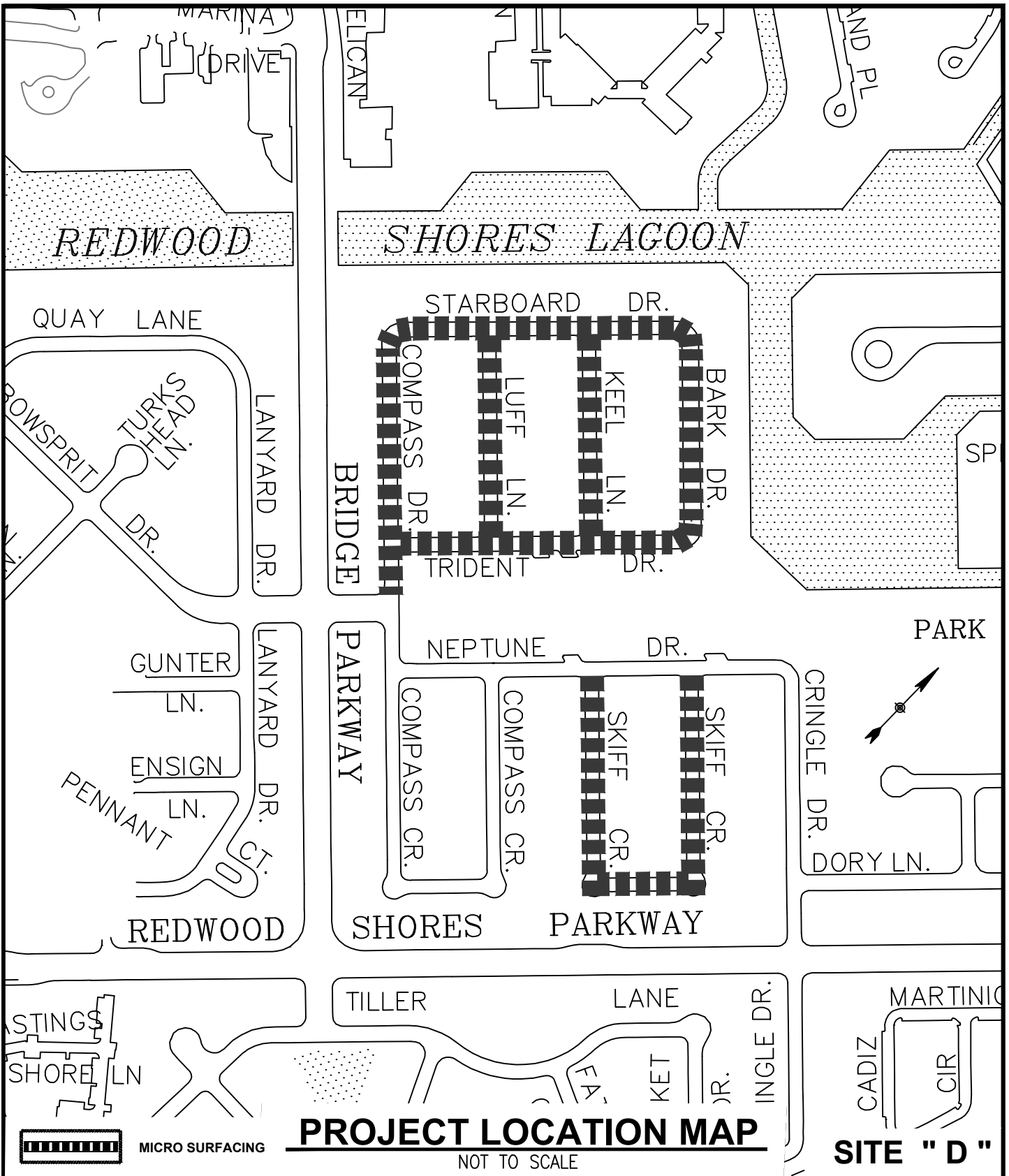

DESIGNED:	DATE: 6/6/16
S. ZAHORI	
DELINEATED:	DATE: 6/6/16
K. NOZUKA	
CHECKED:	DATE:
J. MANZI	
SCALE:	NOT TO SCALE

CITY OF REDWOOD CITY
 COMMUNITY DEVELOPMENT DEPARTMENT
 ENGINEERING AND TRANSPORTATION
 CALIFORNIA

**2015 - 2016 ASPHALT RUBBER CAPE
 SEAL AND SPOT REPAIR PROJECT**